

**BUTTERWICK CONSTRUCTION
& CARPENTRY LTD.**
5628 82 Ave
Edmonton, AB T6B 3E6
Tel: 780.434.3559
www.butterwick.ca

**BROOK
SIDE
RETROFIT**
Edmonton, AB

**BROOK SIDE
RESIDENCE DEEP
ENERGY RETROFIT**

DATE
January 26, 2023

**ISSUED FOR
CONSTRUCTION**

DRAWN BY
PA

WINDOW SCHEDULE

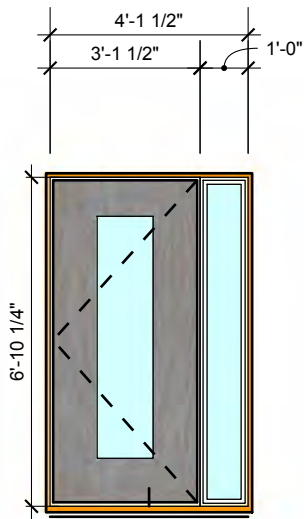

FRONT DOOR

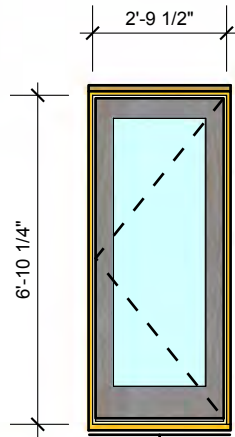

BACK DOOR

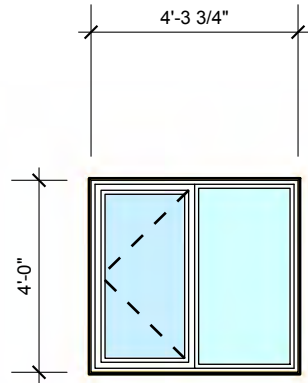

WEST BEDROOMS - 2 REQ'D

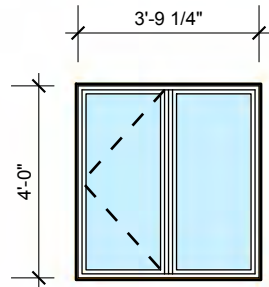

FOYER WEST

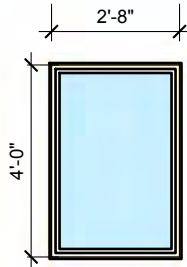

FOYER WEST

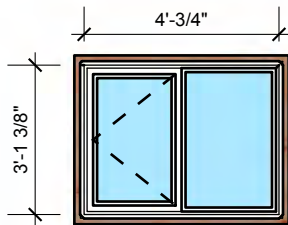

KITCHEN BAY SOUTH

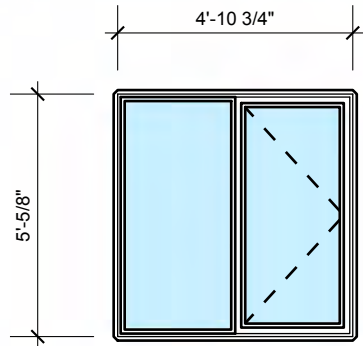

DINING BAY SOUTH

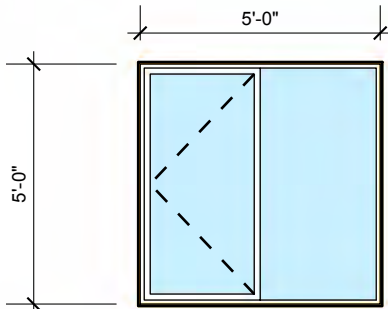

DINING EAST



DINING EAST

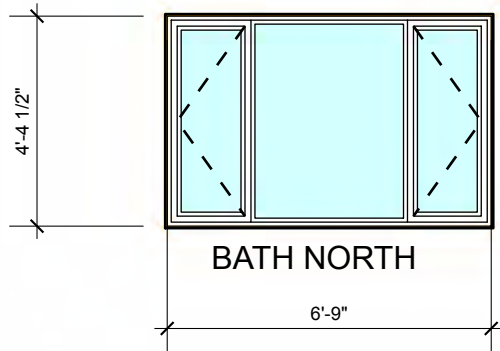

BATH NORTH

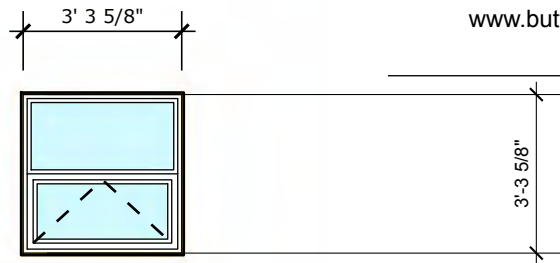

BATHROOM NORTH

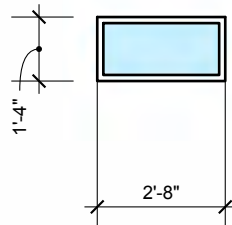

BASEMENT BEDROOM
WEST

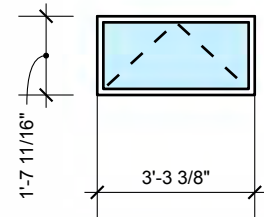

BASEMENT BEDROOM
NORTH WEST

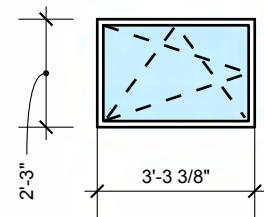

BASEMENT BEDROOM
NORTH WEST

- ALL DIMENSIONS ARE OSM OF FRAME

TRANSITION AIR BARRIER FROM ATTIC
SPRAY FOAM TO PANEL WRB/ AIR BARRIER
WITH A LAYER OF SPRAY FOAM

FILL W/ ROXUL AFTER SPRAY
FOAM AND CELLULOSE FILL

SIGA MAJVEST TRPPED BEHIND 2X2
FOR SPRAY FOAM AND TUCKED
OUT OF THE WAY FOR CELLULOSE FILL

WINDOWS:

NFRC: Energy Star U=0.85 SHGC=0.27 ER=37

NRCan=NR5695-34935108

NAFS: LC-PG45 PDP=2160Pa(45psf) NDP=-2160Pa(-45psf)

WPRTP=720Pa(15.04psf) CAI=Fixed Mullion

NEW RETROFIT PANELS:

- REUSED CEDAR AND LP PANEL SIDING
- 10MM VENTED RAIN SCREEN
- SIGA MAJVEST WRB AND AIR BARRIER:
CONTINUOUS SEALED, VAPOUR OPEN, AIR BARRIER
AND WATER RESISTIVE BARRIER
- 2X4 24" OC W 7/16" OSB
- CAVITY FILLED WITH 8" OF DENSE PACKED CELLULOSE (R28)

PWF PANEL SUPPORT BOX HUNG FROM 2X10 SPF
LEDGER AND FILLED WITH MIN125MM OF
SPRAY FOAM INSULATION

150MM GRAPHITE INFUSED
(NEOPRE) EPS TO FOOTING (R30)

AIR BARRIER PATH

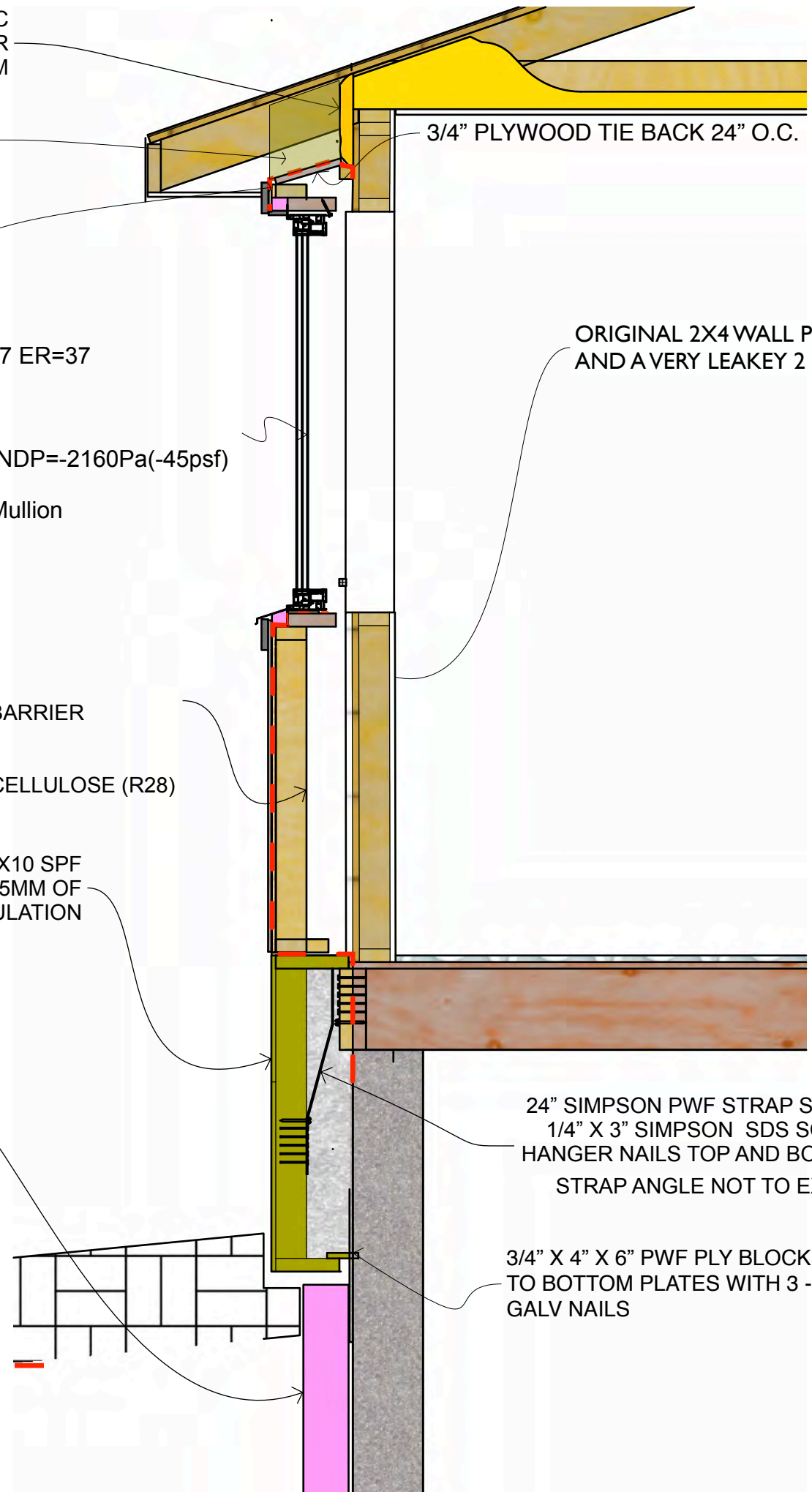

3/4" PLYWOOD TIE BACK 24" O.C.

ORIGINAL 2X4 WALL PRESUMED TO HAVE R10 FIBREGLAS INSULATION
AND A VERY LEAKY 2 MIL VAPOUR BARRIER

REMOVE EXISTING INSULATION
SEAL ATTIC WITH ~ 2" OF SPRAY FOAM
ADD R55 LOOSE FILL CELLULOSE

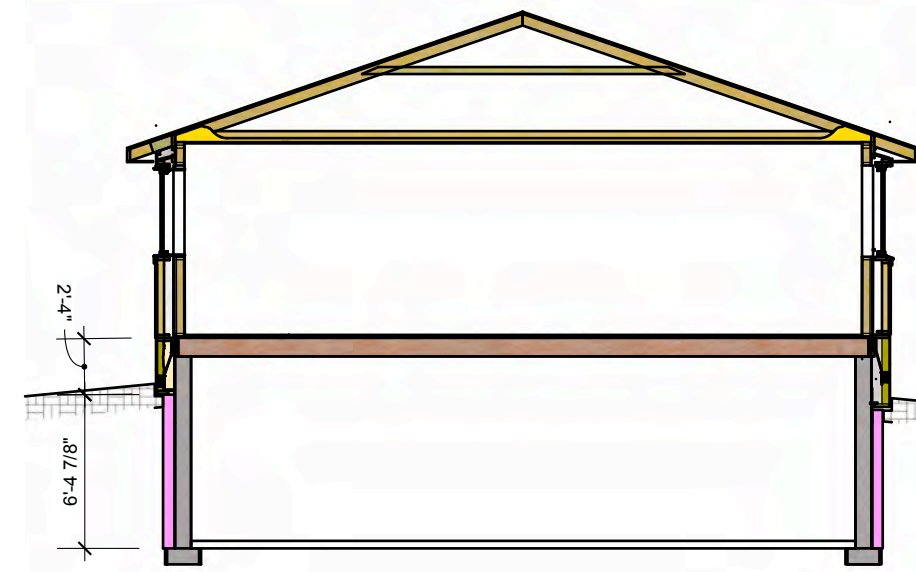

2'-4"
6'-4 7/8"

24" SIMPSON PWF STRAP SECURED WITH ONE
1/4" X 3" SIMPSON SDS SCREW AND 5 - 3 1/4"
HANGER NAILS TOP AND BOTTOM, MAX 24" OC
STRAP ANGLE NOT TO EXCEED 1:3 OR 18.5°

3/4" X 4" X 6" PWF PLY BLOCKS SECURED
TO BOTTOM PLATES WITH 3 - 2 1/2"
GALV NAILS

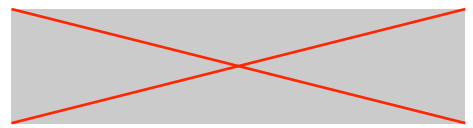

BUTTERWICK CONSTRUCTION
& CARPENTRY LTD.
5628 82 Ave
Edmonton, AB T6B 3E6
Tel: 780.434.3559
www.butterwick.ca

BROOK
SIDE
RETROFIT
Edmonton, AB

BROOK SIDE
RESIDENCE DEEP
ENERGY RETROFIT

DATE
January 26, 2023

ISSUED FOR
CONSTRUCTION

DRAWN BY
PA

SECTION 1

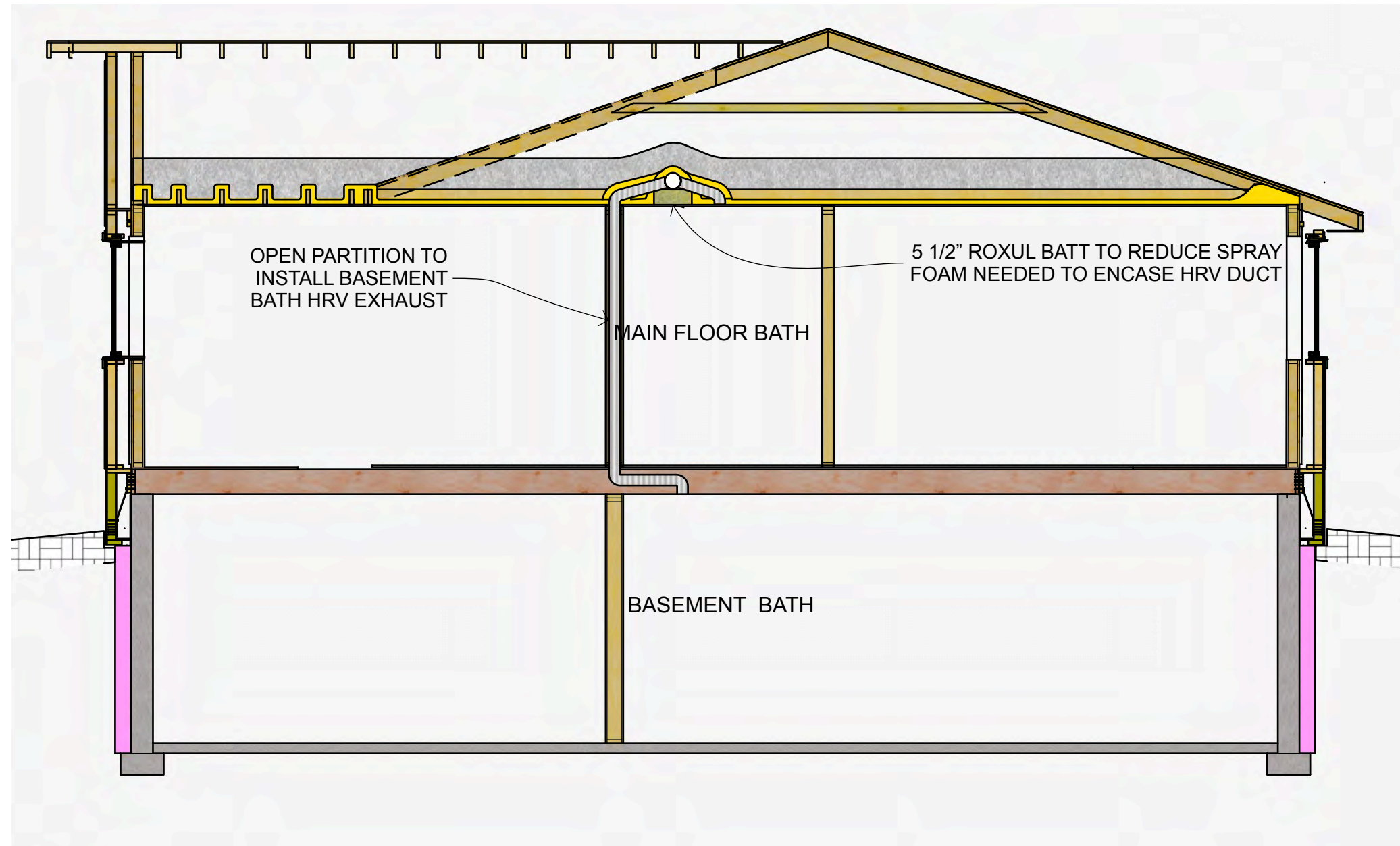
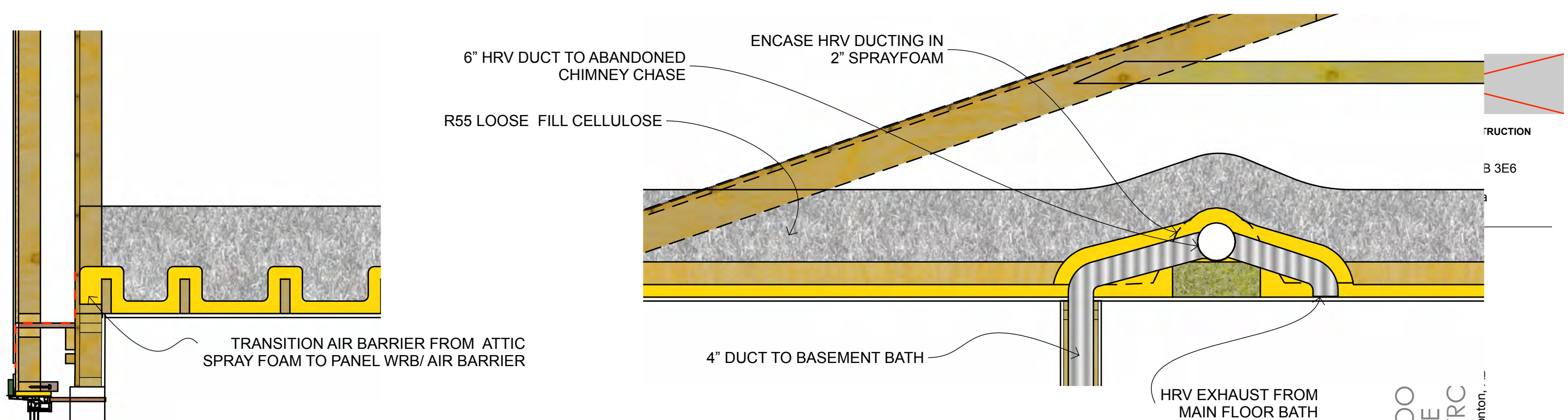

BROOK
SIDE
RETRC
Edmonton, ...

BROOK SIDE
RESIDENCE DEEP
ENERGY RETROFIT

DATE
January 26, 2023

**ISSUED FOR
CONSTRUCTION**

DRAWN BY
PA

SECTION 2

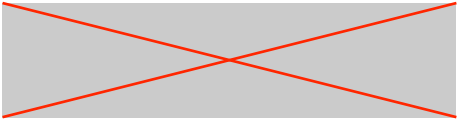

**BUTTERWICK CONSTRUCTION
& CARPENTRY LTD.**
5628 82 Ave
Edmonton, AB T6B 3E6
Tel: 780.434.3559
www.butterwick.ca

**BROOK
SIDE
RETROFIT**
Edmonton, AB

**BROOK SIDE
RESIDENCE DEEP
ENERGY RETROFIT**

DATE
January 26, 2023

**ISSUED FOR
CONSTRUCTION**

DRAWN BY
PA

**WOOD HEATER
DETAILS**

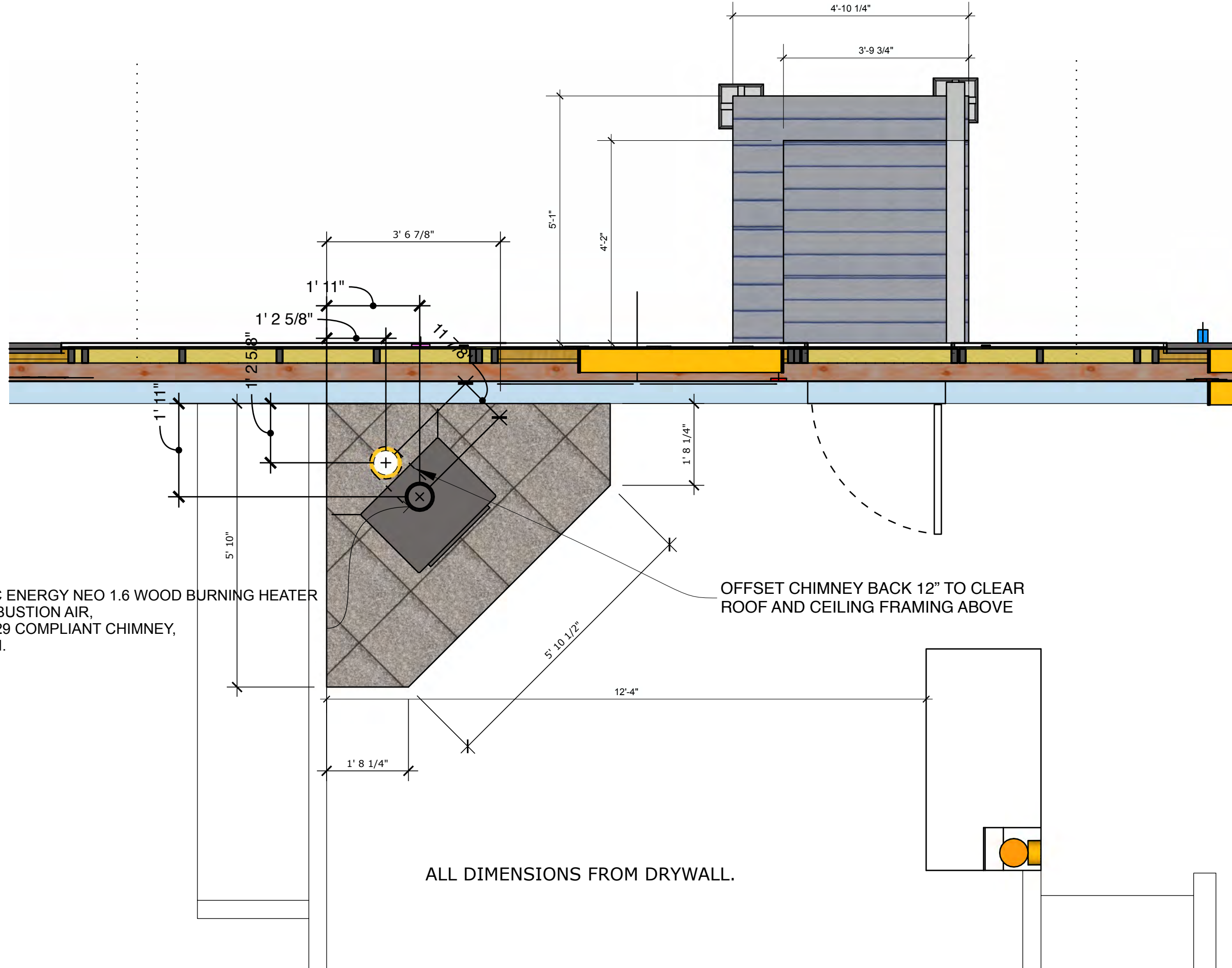

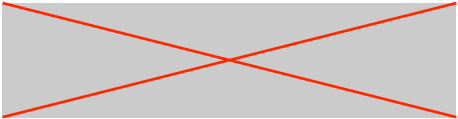

BUTTERWICK CONSTRUCTION
 & CARPENTRY LTD.
 5628 82 Ave
 Edmonton, AB T6B 3E6
 Tel: 780.434.3559
 www.butterwick.ca

BROOK
 SIDE
 RETROFIT
 Edmonton, AB

BROOK SIDE
 RESIDENCE DEEP
 ENERGY RETROFIT

DATE
 January 26, 2023

**ISSUED FOR
 CONSTRUCTION**

DRAWN BY
 PA

ATTIC HATCH
 EXTENSION

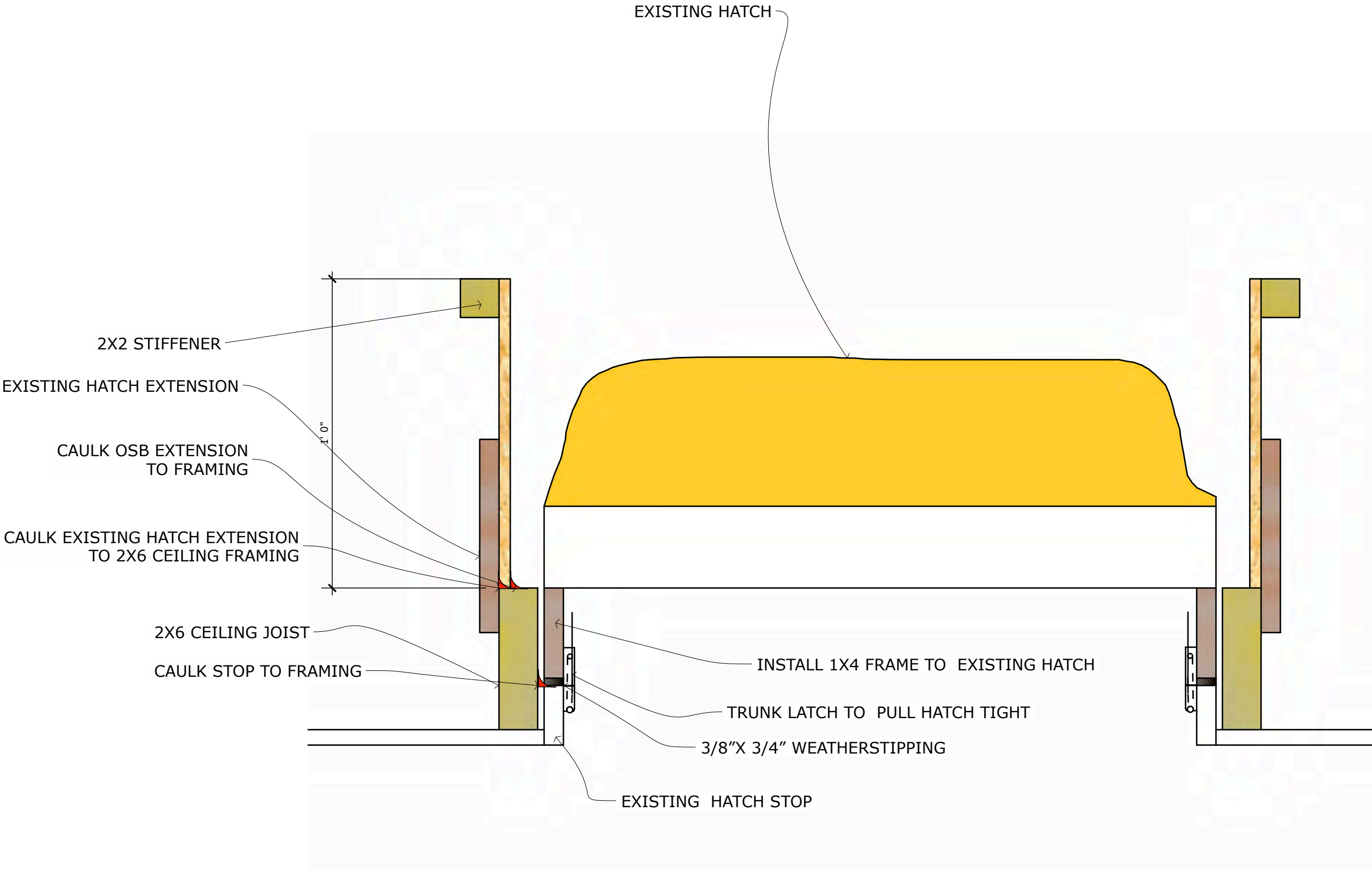

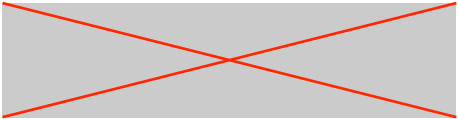

BUTTERWICK CONSTRUCTION & CARPENTRY LTD.
5628 82 Ave
Edmonton, AB T6B 3E6
Tel: 780.434.3559
www.butterwick.ca

BROOK
SIDE
RETROFIT
Edmonton, AB

BROOK SIDE
RESIDENCE DEEP
ENERGY RETROFIT

DATE
January 26, 2023

ISSUED FOR
CONSTRUCTION

DRAWN BY
PA

DECK FRAMING

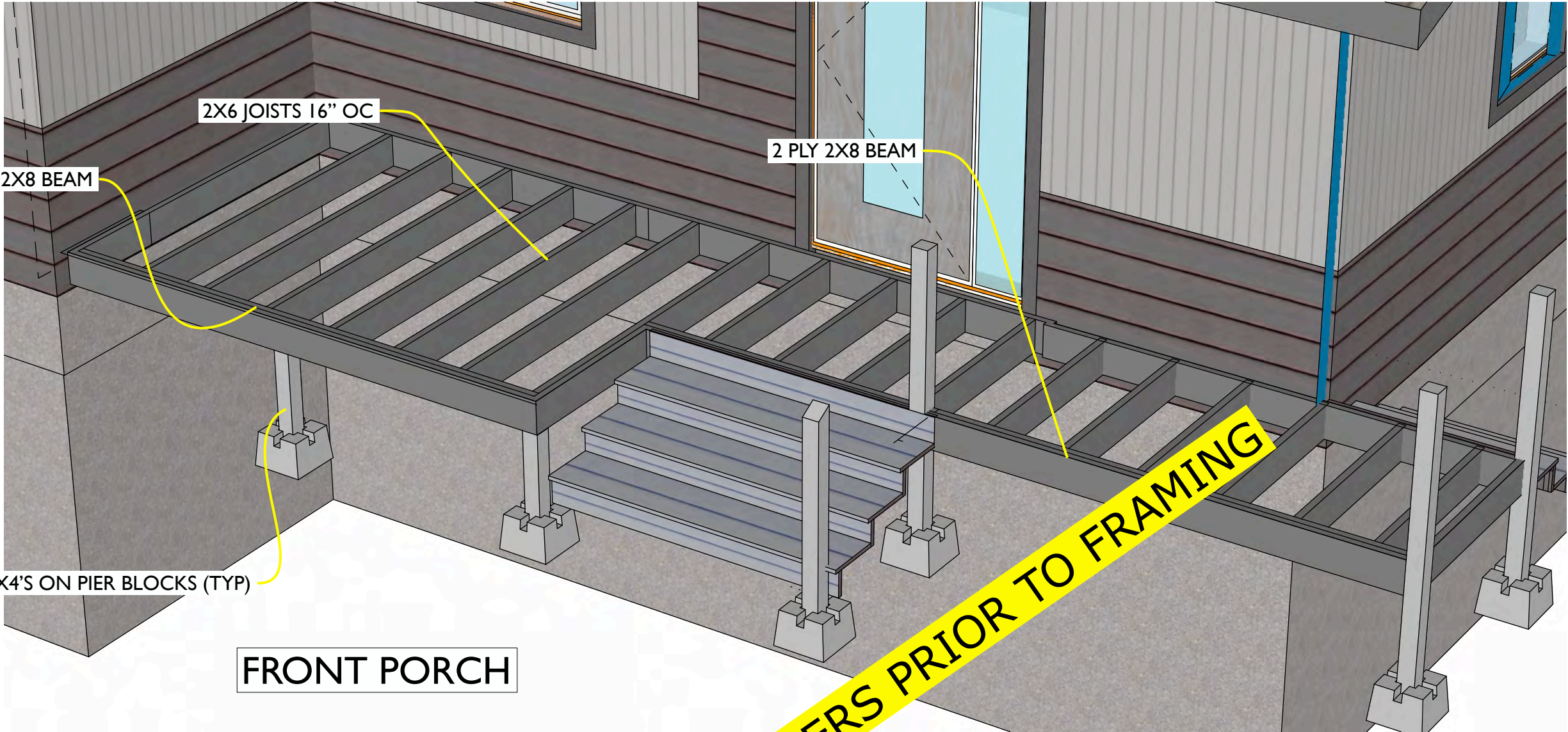

FRONT PORCH

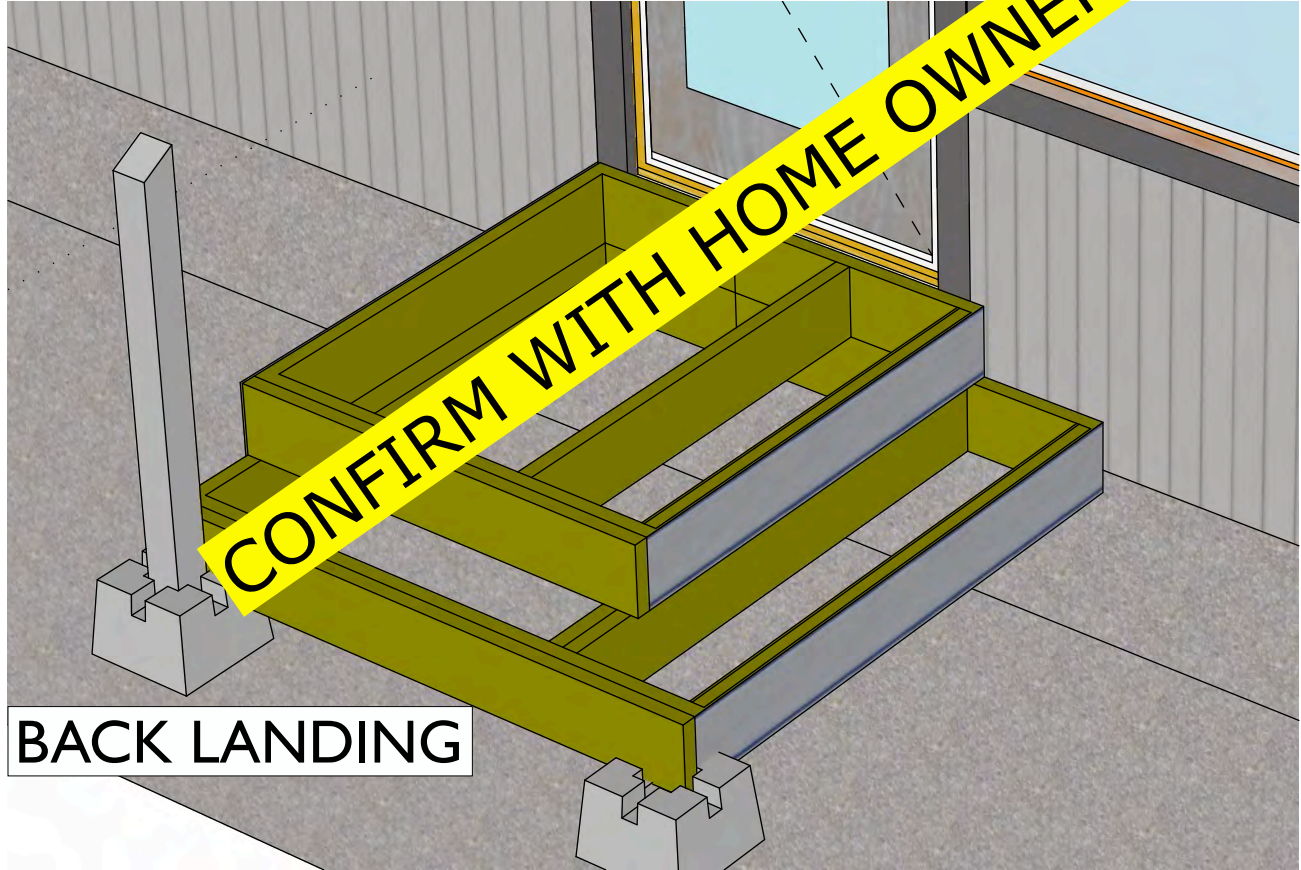

BACK LANDING